

# HunterDouglasContract

WINDOW COVERINGS

CEILING

SOLAR CONTROL



Hunter Douglas Contract  
5015 Oakbrook Parkway, Suite 100  
Norcross, GA 30093  
phone: 800.366.4327  
fax: 770.806.0214  
[www.hunterdouglascontract.com/ceilings](http://www.hunterdouglascontract.com/ceilings)



**LUXALON®**  
METAL CEILINGS

**HunterDouglasContract**

CEILINGS



**Innovative products  
make innovative projects.**



Forty years ago, we pioneered suspended metal ceilings. We've been hard at work ever since, developing products to meet the demands of innovative architects and designers. We've crafted a comprehensive range of Luxalon® Metal Ceilings that excel in design and performance, with solutions from Linear and Wide Panel to Curved, Plank, and Tile. Each is available in a variety of styles, colors, and finishes, guaranteeing that no matter your vision, we've got the look you're after. Just dream it up. We'll be ready.

WOOD LOOK 2

PLANK & TILE 4

CURVED PRODUCTS 8

WIDE PANEL 10

LINEAR 12

EXTERIOR SOFFIT 16

CELL 18

BAFFLE 20

XL PANEL 22

# Go with the grain.

We don't believe creativity should be stifled by the limitations of material. That's why we've created ceilings that offer the look of wood with the convenience and performance of metal. Products like 84R, Open Cell, and the Box Series of Linear metal ceilings are available in a variety of finishes, from real wood veneers to amazing laminates, allowing you to create looks you never thought possible.



*Left:* Plainfield Medical Center, Indianapolis, IN  
Architect: BSA Lifestructures  
Product: Box 4, veneer: Maple

*Right:* GSO Day Theatre & Arts Complex, Greensboro, NC  
Architect: Calloway, Johnson, Moore & West, PA  
Product: 84R, veneer: White Oak





Luxalon® Plank and Tile ceilings by Hunter Douglas blend style and functionality, offering a clean, monolithic look and a variety of options. Our precision engineering results in consistently flat panels. Lay-In, Snap-In, Hook-On, and Torsion Spring Plank and Tile systems offer optimal access to the plenum. Various perforation patterns, sizes up to 2' x 10', and the availability of exterior applications ensure that everyone can have their own sense of Tile.

## It's hip to be square. Or rectangular.



*Far Left:* Austin City Hall, Austin, TX  
 Architect: Antoine Predock and Cotera Kolar Negrete & Reed  
 Product: Snap-In Plank, custom color: Bronze

*Left:* Toei Oedo Transportation Station, Nakai, Japan  
 Architect: Tokyo Metropolitan Government Bureau of Transportation  
 Product: Snap-In Plank, Tile

*Above:* Shenzhen National Tax Bureau, Guangdong, China  
 Architect: Huadian Decoration Co.  
 Product: Snap-In Plank, Tile



PLANK & TILE



*Above:* Inmobiliaria Security, Las Condes, Chile  
Architect: Alemparte-Barreda and Associates  
Product: Lay-In Tile

*Right:* Sony Metreon, San Francisco, CA  
Architect: Simon Martin Vegue-Winkelstein Morris  
and Handel Architects  
Product: Snap-In Tile, color: Anodized





**HOOK-ON**

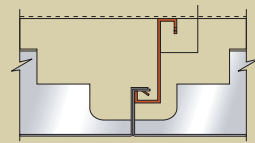

**SNAP-IN**

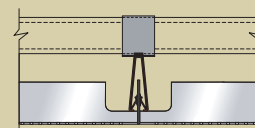

**TORSION SPRING**

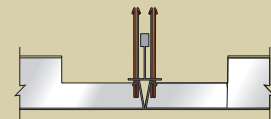

**LAY-IN REVEAL EDGE**

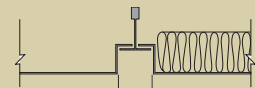

**LAY-IN REVEAL EDGE  
SLOTTED GRID**

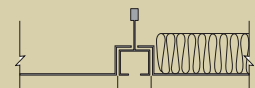



*Above:* Carnegie Mellon at NASA Ames Research Center,  
Mountain View, CA  
Architect: Architectural Resources Group  
Product: Curved Solutions 250, color: Cotton White

*Right:* Office Building, Thornton, CO  
Architect: Neenan Company  
Product: Curved Solutions 250, color: Natural

*Far Right:* Ricardo Cumming Metro Station, Santiago, Chile  
Architect: Gubbins Architects and Burmeister Consultants  
Product: Curved XL Panel



## Ahead of the curve.

Luxalon® Curved Products bring artistic freedom to the forefront. Panels up to 2' x 8' allow you to define spaces both large and small. A growing design trend, these panels feature excellent acoustical properties and a variety of arch-lengths and radii that are perfect for creating arches and multilevel designs.



# Impressive size. Impressive look.

Our 300mm Wide Panel ceilings create a distinct, smooth look. We offer a selection of cost-effective options to suit your project, including interior and exterior applications, perforations that provide exceptional acoustical performance, lengths up to 19'6", and three distinct joint details. Whether you prefer a defined reveal or a monolithic finish, Luxalon® Wide Panel is the quick way to make a big first impression.

## 300A

Clean 10mm wide reveal

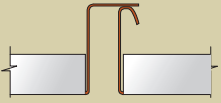

## 300C

Neat V-joint

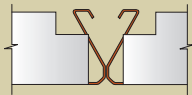

## 300L

Monolithic square edge

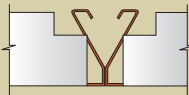

*Middle:* Told & Skat Toldburen, Naestved, Denmark  
 Architect: Jensen + Jørgensen + Wohlfeldt  
 Product: 300C, color: White

*Far Top:* JFK, Terminal 1, New York, NY  
 Architect: William Nicholas Bodouva & Associates  
 Product: 300C, color: Natural

*Far Middle:* Guangzhou International Events Center, Guangzhou, China  
 Architect: South China Science and Engineering University Architect and Design Institute  
 Product: 300C

*Far Bottom:* Luohu Sports Center, Shenzhen, China  
 Architect: Huazhu Architect and Design Institute  
 Product: 300C







Luxalon® Linear metal ceiling systems highlight versatility, allowing a variety of innovative interior and exterior visual effects. Explore the softly rounded edges of 84R or use the clean, square corners and multiple depth options of the Box Series to create a multilayered look.



*Left:* Reebok World Headquarters, Canton, MA  
 Architect: NBBJ Architects of Seattle  
 Product: Box 4, color: Natural

*Above:* Icebar, Nordic Sea Hotel, Stockholm, Sweden  
 Architect: Lars Phil, Jan Söder, Ake Larsson, and Arne Bergh  
 Product: 150C, color: White

*Right:* Schiphol Airport Terminal, Amsterdam, the Netherlands  
 Architect: Bentheim Crouwel Architects  
 Product: Box 6, color: White

## In line with style.





# LINEAR

No matter your style, Linear has the looks you love. Choose from a multitude of available colors or mix and match different sizes to create the perfect look for your project with our universal carrier system. Select a curved carrier or play it straight. Our Linear ceilings give you the freedom to create, whatever your project's needs.

*Left: NEWater Visitor Centre, Tanah Merah, Singapore  
Architect: CH2M HILL Singapore Pte, Ltd.  
Product: 84R*

*Below: BART Station, San Francisco, CA  
Architect: ED2 International  
Product: Box 6, color: Natural*



*Right, Top to Bottom:*  
Washington State Convention and Trade Center, Seattle, WA  
Architect: TRA Architecture Engineering Planning Interiors  
Product: Box 4

The Foreign Office Building, Xinhua, China  
Architect: Building Design Institute Ministry of Construction, P.R.C.  
Product: 84R

Stillwater High School, Stillwater, MN  
Architect: Armstrong, Torseth, Skold & Rydeen  
Product: Curved 84R, color: Cotton White





# Take it outside.

*Left to Right:*

St. Luke's Professional Building, Houston, TX  
 Architect: Cesar Pelli & Associates  
 Product: Snap-In Tile, custom color: Taupe

Coima Railway Station, Coima, Portugal  
 Architect: Mata Guedes  
 Product: 300L

Reebok World Headquarters, Canton, MA  
 Architect: NBBJ Architects of Seattle  
 Product: 300C

Why keep your vision locked inside? Bring style outdoors with our Exterior Soffit ceilings. These products create a variety of distinct looks and are engineered to withstand severe weather conditions. Perfect for canopies and porte-cocheres, our Linear, Wide Panel, Plank, and Tile systems are all available for exterior usage.



# The great wide open.

Our Open Cell ceilings provide the widest selection of patterns, configurations, and colors, inviting you to exercise your creativity. Both our Open Cell and larger Cell Frame ceilings offer a clean fit, establishing a monolithic visual plane. In addition, our Cell ceilings provide access to lighting, ventilation systems, and sprinklers, ensuring form doesn't get in the way of function.





*Above:* Retail Space, Las Vegas, NV  
Architect: Pavlik Design Team  
Product: 6" Cell Frame, color: White

*Left:* Messe München International, München, Germany  
Architect: Obermeyer Planen + Beraten  
Product: Open Cell 50E, color: Off-White

*Far Left:* 7th Street Parking Garage, Minneapolis, MN  
Architect: Stageberg Beyer Sachs  
Product: Open Cell, color: Gloss Blue





*Above:* Crown Coliseum, Fayetteville, NC  
Architect: Odell  
Product: Custom Baffle

*Left:* Ft. Lauderdale Airport, Ft. Lauderdale, FL  
Architect: HOK  
Product: Metal Screen/Baffle

*Right:* Lynnhaven Mall, Lynnhaven, VA  
Architect: Copeland, Novak & Israel  
Product: Metal Screen/Baffle



BAFFLE

## Get baffled.

Luxalon® Baffle ceilings emphasize versatility. Our adjustable carrier allows Baffles to slide back for easy access to lighting, sprinklers, and diffusers. Use Baffle ceilings as a one-way plenum mask or to create interesting lighting effects. Utilize Baffle on its own or incorporate other Luxalon metal ceilings in adjoining areas for a comprehensive design.



## Super-size your ceiling.

We've borrowed technology from the aircraft industry to create Luxalon® XL Panels, which span up to 5' in width and 15' in length. Despite their size, XL Panels remain flat, light, and need minimal supporting points. Clean, monolithic panels provide a smooth appearance and are available in a variety of finishes. Ideal for convention and transportation centers, sports arenas and educational establishments, they're the latest in a history of big ideas.

*Right:* Changi Airport, Changi, Singapore  
Architect: Airport Development Division, PWD  
Product: XL Panel





Large Photo, Right:

Sony Metreon, San Francisco, CA  
Architect: Simon Martin Vegue-Winkelstein Morris  
and Handel Architects  
Product: Snap-In Tile, color: Anodized



Above, Left to Right:

Lida Baday, New York, NY  
Architect: Zuliani + Associates  
Product: Techstyle 4' x 4' Panels, color: White

TKG Consulting, San Diego, CA  
Architect: Architects Wilke, Rodrigues & Barker  
Product: Techstyle 4' x 4' Panels, color: White

John & Mary Pappajohn Center for Higher Education  
Center, Des Moines, IA  
Architect: Herbert Lewis Kruse Blunck Architecture  
Product: Techstyle 4' x 4' Panels, color: White

Seagate Technologies, Colorado Springs, CO  
Architect: Pope Architects  
Product: Techstyle 4' x 4' Panels, color: White

Cover: Austin City Hall, Austin, TX  
Architect: Antoine Predock and Cotera Kolar Negrete  
& Reed  
Product: Snap-In Plank, custom color: Bronze



## LUXALON CEILINGS' ENVIRONMENTAL BENEFITS

No VOC's (Volatile Organic Compounds), preserves IAQ (indoor air quality)

70% recycled content

Durable panels ensure long product lifespan and maximize sustainability

100% recyclable

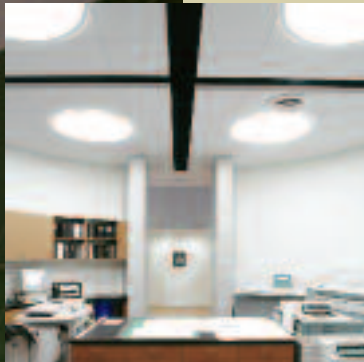

For the last 80 years, we've worked alongside the architecture and design community, creating some of the world's most recognizable projects. We're continually striving to fulfill the needs of architects and designers, crafting products that meet the highest standards. Our Luxalon® Metal Ceilings and Techstyle® Acoustical Ceilings have been developed to assist the architects of today in designing the projects of tomorrow.

*Innovative products make innovative projects.*

## Learn More

- Call 800.366.4327 to speak with a customer service specialist
- Visit [www.hunterdouglascontract.com/ceilings](http://www.hunterdouglascontract.com/ceilings)
- Sign up for *Profiles*, our international email bulletin